

HDMI over Wireless Extender

User Manual

Thank you for purchasing this product

For optimum performance and safety, please read these instructions carefully before connecting, operating or adjusting this product. Please keep this manual for future reference.

Surge protection device recommended

This product contains sensitive electrical components that may be damaged by electrical spikes, surges, electric shock, lightning strikes, etc. Use of surge protection systems is highly recommended in order to protect and extend the life of your equipment.

Table of Contents

1. Introduction	2
2. Features	2
3. Package Contents.....	3
4. Specifications	3
5. Operation Controls and Functions	5
6. Connection Diagram	7

1. Introduction

The HDMI over wireless kit extends high-definition video and audio to any HDTV displays up to 100 meters away. It supports up to 4 displays to show one source content synchronously and resolutions up to 1080p. The extender transmits the vivid real time video and audio signals with very low latency, allowing user to view the content in other rooms of the house, such as bedroom, living room, or kitchen. It also allows user to control source device from display side via source device's remote controller.

2. Features

- ✧ Digital 2.4G & 5GHz dual frequency wireless A/V transmission
- ✧ HDMI 1.4b (6.75Gbps), HDCP 1.4 and DVI compliant
- ✧ Full HD 1080p transmits up to 100 meters wirelessly in open space
- ✧ Supports Point-to-Point and Multicast transmission (up to 4 receivers)
- ✧ Extends infrared remote to control source device from display side
- ✧ USB HID transmission from display to source
- ✧ Simple Plug and Play, no software installation required

3. Package Contents

- ✧ 1 x HDMI over Wireless Transmitter
- ✧ 1 x HDMI over Wireless Receiver
- ✧ 1 x Wideband IR Blaster cable
- ✧ 1 x Wideband IR Receiver cable
- ✧ 2 x 5V/1A Power Adaptor
- ✧ 1 x User Manual

4. Specifications

Technical	
HDMI Compliance	HDMI 1.4b
HDCP Compliance	HDCP 1.4
Video Bandwidth	6.75 Gbps
Video Resolutions	up to 1080P@50/60Hz
Color Space	RGB, YCbCr 4:4:4, YCbCr 4:2:2
Color Depth	8-bit
HDMI Audio Formats	LPCM 2CH
Wireless Standard	802.11a/b/g/n
Modulation Method	BPSK/QPSK/16-QAM/64-QAM
Wireless Band	2.4GHz, 5GHz ISM Band
Operation Range	Up to 100 meters in open space
IR Frequency	20KHz - 60KHz
ESD Protection	Human body model — ±8kV (air-gap discharge) & ±4kV (contact discharge)

Connections	
Transmitter	Inputs: 1x HDMI Type A [19-pin female] Outputs: 1x HDMI Type A [19-pin female] 1x USB [Mini USB Type] 1x IR Out [3.5mm Stereo Mini-jack]
Receiver	Inputs: 2x USB [USB Type A] 1x IR In [3.5mm Stereo Mini-jack] Outputs: 1x HDMI Type A [19-pin female]
Mechanical	
Housing	Aluminum Enclosure
Color	Black
Dimensions	142mm [W] x 80mm [D] x 19mm [H]
Weight	TX: 270g RX: 260g
Power Supply	Input: AC100 - 240V 50/60Hz Output: DC 5V/1A (US/EU standards, CE/FCC/UL certified)
Power Consumption	3W (Max)
Operation Temperature	32 - 104°F / 0 - 40°C
Storage temperature	-4 - 140°F / -20 - 60°C
Relative Humidity	20 - 90% RH (no condensation)

5. Operation Controls and Functions

5.1 Front Panel

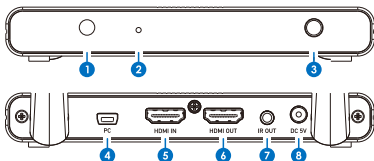

- 1 IR Emitter:** IR emitter window.
- 2 Power LED:** System power indicator LED.
- 3 Pair:** Press this button to pair with receiver at first time. Once established connection, TX and RX will auto pair each other at next time power on.
- 4 PC:** USB device port, connecting to PC/laptop USB port.
- 5 HDMI In:** Connect to an HDMI source device.
- 6 HDMI Out:** Connect to an HDMI display device.
- 7 IR Out:** Connect to an IR emitter cable and put IR emitter header close to source device's IR receiver window.
- 8 DC 5V:** Connect 5V/1A adaptor for power supply.

5.2 Rear Panel

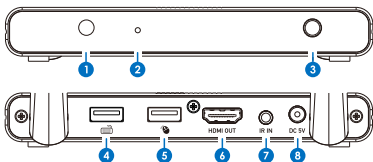

- 1 IR Receiver:** IR receiver window.
- 2 Power LED:** System power indicator LED.
- 3 Pair:** Press this button to pair with transmitter. Once established connection, TX and RX will auto pair each other at next time power on.
- 4 USB Keyboard:** Connect to an USB keyboard.
- 5 USB Mouse:** Connect to an USB mouse.
- 6 HDMI Out:** Connect to an HDMI display device.
- 7 IR In:** Connect to an IR receiver cable and put IR receiver header close to display device's IR receiver window.
- 8 DC 5V:** Connect 5V/1A adaptor for power supply.

6. Connection Diagram

